

SIGNAL EQUIPMENT			
(1) 8 PHASE FULLY ACTUATED STANDARD 2070 CONTROLLER WITH FLASHER, SIGNAL MONITOR UNIT, AND POLE MOUNTED 336 CABINET.			
(4) PUSH BUTTONS			
(2) SIGN "A" EMERGENCY SIGNAL			
(1) RADIO RECEIVER AND COAX CABLE AND ANTENNA			
(2) RADIO TRANSMITTER AND ANTENNA			
SIGNAL HEAD DISPLAY CHART			
HEAD NUMBER	2	4	6
DISPLAY (LED)			
PHASE	2	4	6
SIZE	12"/8"	12"	12"/8"
QUANTITY	2	2	2

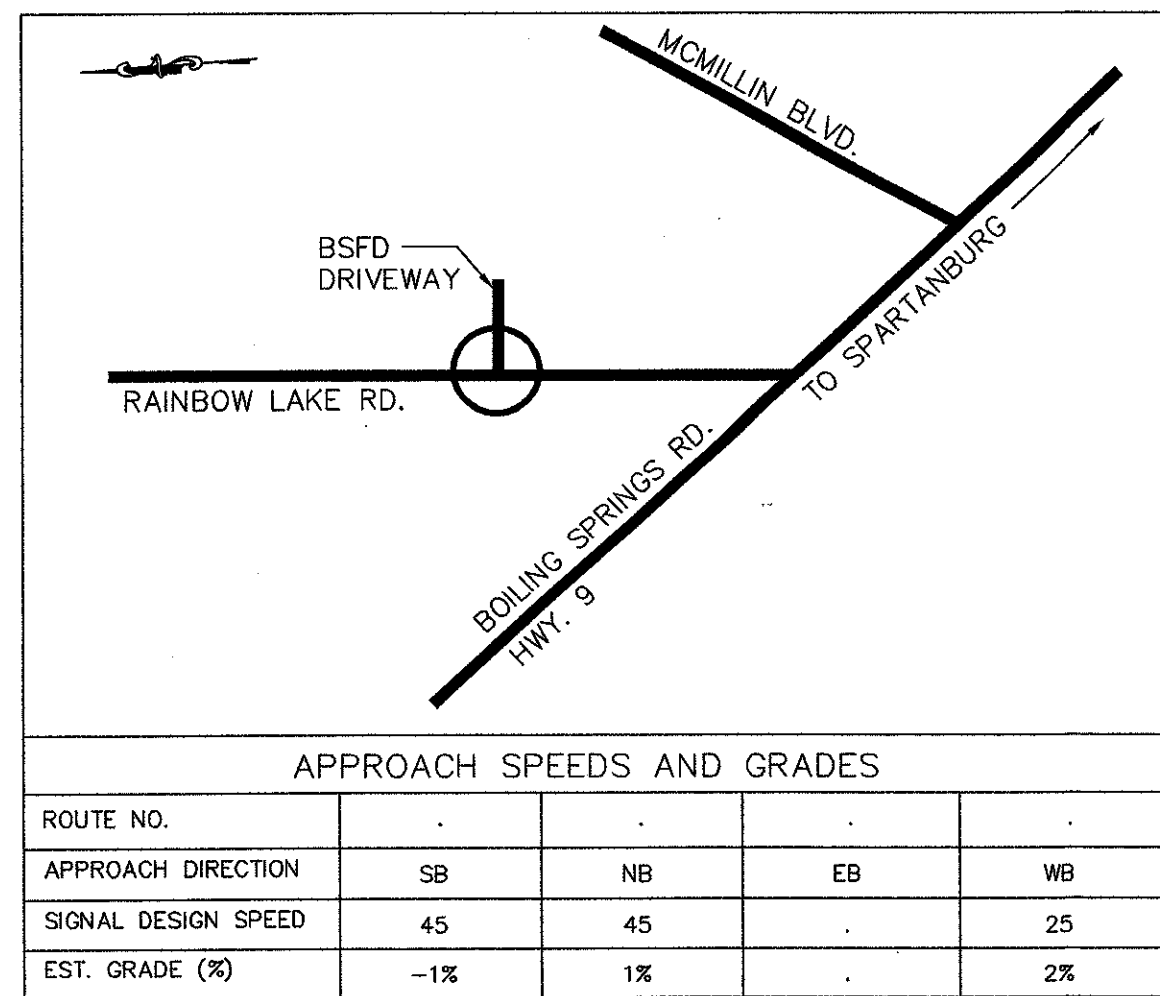

PRE-EMPTION NOTES

- ONE (1) PUSH BUTTON IN FIRE DEPT. AND ONE (1) PUSH BUTTON IN EMS FOR NORTH BOUND EMERGENCY VEHICLES.
- ONE (1) PUSH BUTTON IN FIRE DEPT. AND ONE (1) PUSH BUTTON IN EMS FOR SOUTH BOUND EMERGENCY VEHICLES AT THIS SIGNAL AND SIGNALS AT LOWES AND SC 9.

PROJECT INSTALLATION NOTES

- A PRECONSTRUCTION MEETING SHALL BE HELD WITH THE SCDOT SIGNAL INSPECTOR BEFORE ANY CONSTRUCTION BEGINS. THE MEETING MUST BE SCHEDULED AT LEAST 48 HOURS IN ADVANCE.
- ALL EQUIPMENT, MATERIALS, AND INSTALLATION PROCEDURES SHALL ADHERE TO THE SCDOT SIGNAL EQUIPMENT SPECIFICATIONS. FOR THE LATEST VERSION, CONTACT SCDOT TRAFFIC ENGINEERING IN COLUMBIA (803) 737-1646 OR OBTAIN FROM SCDOT INTERNET SITE.
- INSTALL (1) 8 CONDUCTOR SIGNAL CABLE FOR SIGNAL HEADS ON EACH APPROACH.
- PROJECT INCLUDES STOP BARS AS SHOWN.
- PROJECT INCLUDES RECEIVERS AND PRE-EMPT INPUT AT TWO EXISTING SIGNALS. SEE REVISED PLANS FOR THOSE SIGNALS.
- FIRE DEPARTMENT REQUIRED TO OBTAIN PERMIT AND REQUEST ELECTRICAL SERVICE. FIRE DEPARTMENT RESPONSIBLE FOR ELECTRIC BILL.

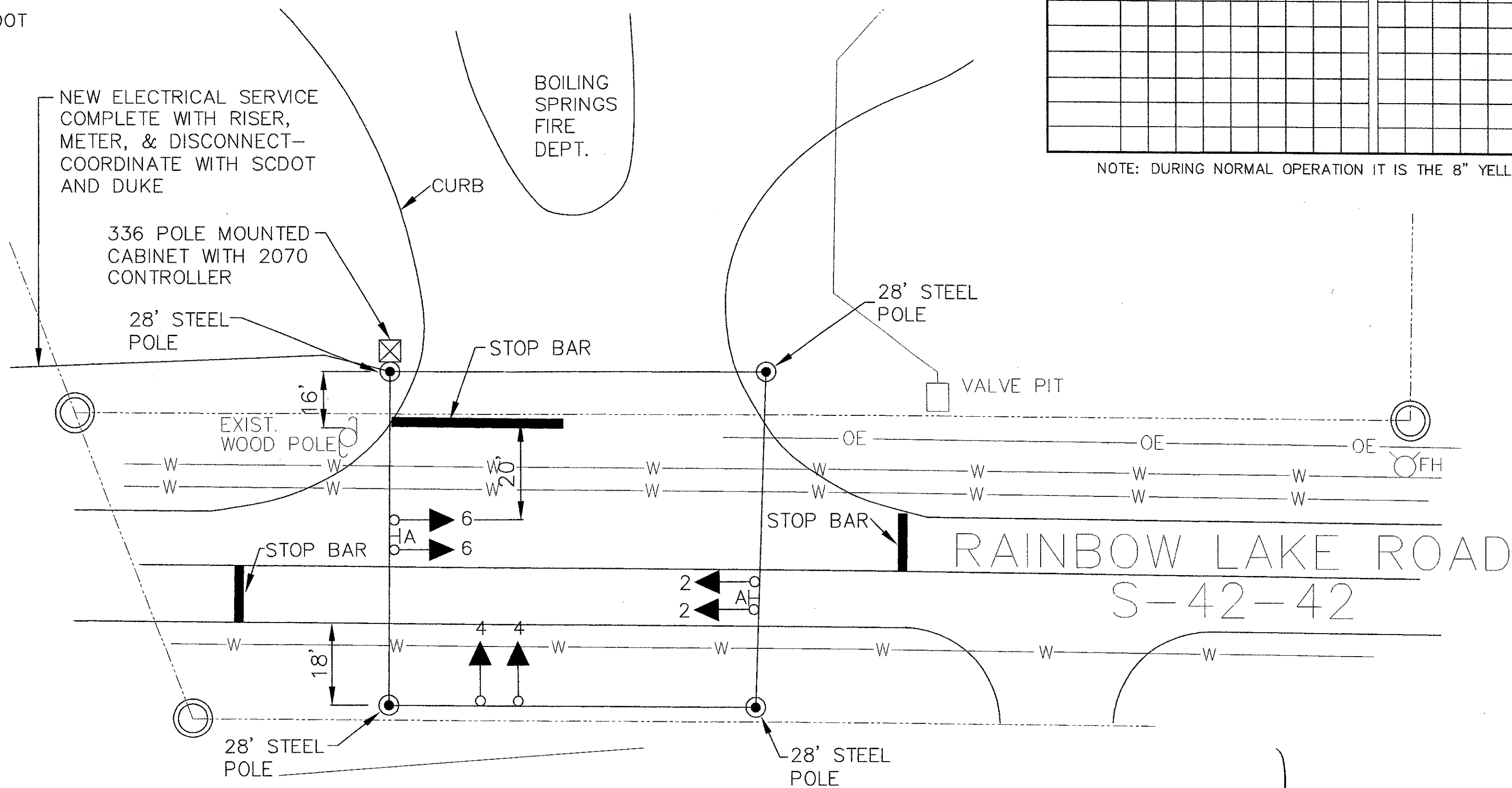
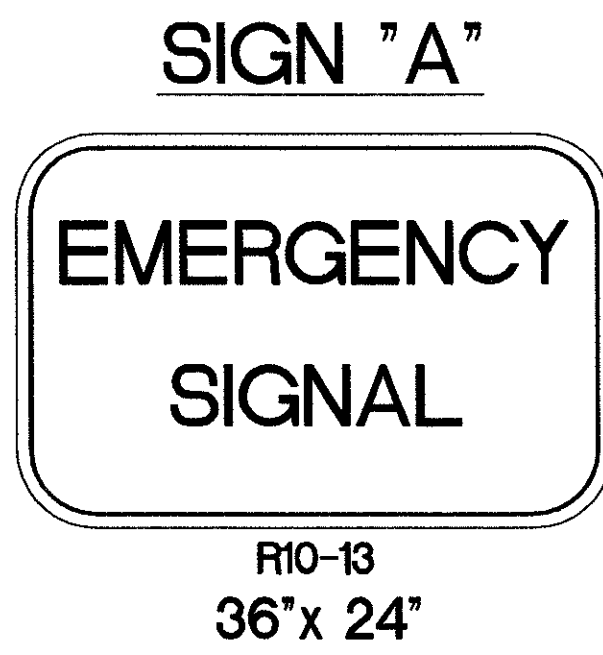

SIGNAL DISPLAY SEQUENCE (PREFERENTIAL PHASING)													
FLASH	SIGNAL HEAD NUMBER	PHASES 2 & 6 CLEAR TO 4				PHASES 4 CLEAR TO 2				PHASES 4 CLEAR TO 6			
		R	W	BARRIER	BAR	R	W	BARRIER	BAR	R	W	BARRIER	BAR
Y	2												
R	4												
Y	6												

ALTERNATE PHASES													
FLASH	SIGNAL HEAD NUMBER	PHASES 1 & 6 CLEAR TO 4				PHASES 2 & 5 CLEAR TO 4				PHASES 3 & 8 CLEAR TO 4			
		R	W	BARRIER	BAR	R	W	BARRIER	BAR	R	W	BARRIER	BAR

NOTE: DURING NORMAL OPERATION IT IS THE 8" YELLOWS ON RAINBOW LAKE ROAD THAT FLASH.

FUNCTIONS	EMERGENCY SIGNAL TIMINGS							
	Ø1	Ø2	Ø3	Ø4	Ø5	Ø6	Ø7	Ø8
WALK	-	-	-	-	-	-	-	-
DON'T WALK	-	-	-	-	-	-	-	-
MIN. INITIAL	-	-	-	30	-	-	-	-
MAX. INITIAL	-	-	-	30	-	-	-	-
ADD/VEH	-	-	-	-	-	-	-	-
VEHICLE EXTENSION	-	-	-	-	-	-	-	-
TIME BEFORE REDUCE	-	-	-	-	-	-	-	-
TIME TO REDUCE	-	-	-	-	-	-	-	-
MIN. GAP	-	-	-	-	-	-	-	-
MAX. LIMIT	-	-	-	-	-	-	-	-
MAXIMUM II	-	-	-	-	-	-	-	-
REDUCE BY	-	-	-	-	-	-	-	-
DYNAMIC MAX	-	-	-	-	-	-	-	-
MAX STEP	-	-	-	-	-	-	-	-
YELLOW CHANGE	-	4.4	-	3.0	-	4.4	-	-
RED CLEARANCE	-	2.0	-	2.5	-	2.0	-	-
RECALL	-	MIN	-	OFF	-	MIN	-	-

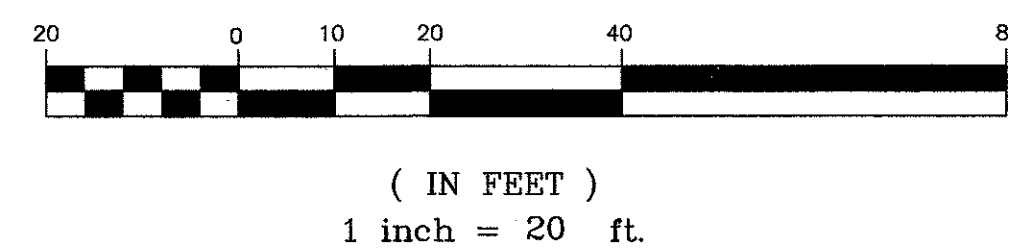

CAUTION

PALMETTO UTILITY PROTECTION SERVICE

3 DAYS BEFORE DIGGING CALL
TOLL FREE 1-800-922-0983

A ONE CALL SYSTEM FOR COMMUNITY AND JOB SAFETY.

THE UTILITIES SHOWN ARE SHOWN FOR THE CONTRACTOR'S CONVENIENCE ONLY. THERE MAY BE OTHER UTILITIES NOT SHOWN ON THESE PLANS. THE ENGINEER ASSUMES NO RESPONSIBILITY FOR THE LOCATIONS SHOWN AND IT SHALL BE THE CONTRACTOR'S RESPONSIBILITY TO VERIFY THE LOCATIONS OF ALL UTILITIES WITHIN THE LIMITS OF THE WORK. ALL DAMAGE MADE TO EXISTING UTILITIES BY THE CONTRACTOR SHALL BE THE SOLE RESPONSIBILITY OF THE CONTRACTOR.

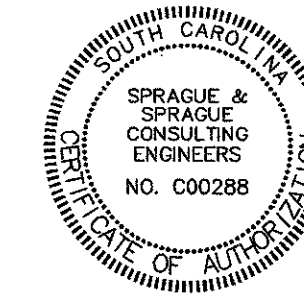
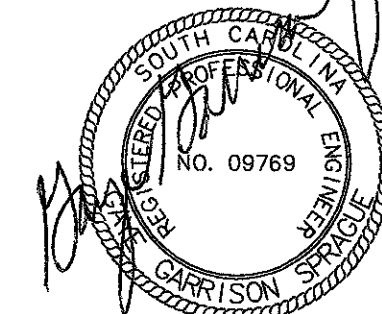

8/17/10

DATE PLOTTED: 8/19/10		FILE NO.: 10-01SP-GGS	
DESIGNED GGS		APPROVED BY	
DRAWN GLY		APPROVED BY	
CHECKED GGS		DIR. OF TRAFFIC ENGINEERING	
REVIEWED GGS		ENGINEER	
RECOMMENDED		SCALE 1" = 20'	DATE 8/16/10
		SHEET NO. 1 of 1	INDEX NO.

- LEGEND**
- TRAFFIC SIGNAL HEAD
 - PEDESTRIAN HEAD w/PUSH BUTTON AND SIGN ASSEMBLY
 - STEEL POLE
 - JUNCTION BOX
 - CABINET AND CONTROLLER
 - UNDERGROUND CONDUIT
 - ELECTRICAL SERVICE PEDESTAL
 - LOOP (6' x VARIOUS)
 - QUADRAPOLE LOOP (6' x 30')